

# INSTALLATION INSTRUCTIONS

DESCRIPTION: Radiator Fan Kit

PART NUMBER: B3J-E24E0-V0

MODEL: '19~ YZ450FX



## **⚠WARNING**

Please read and understand these instructions completely before installation to avoid possible injury, or damage to the accessory or vehicle.

## **NOTICE:**

Installation of this kit requires specialized tools and training. This installation should be performed by an authorized Yamaha dealer or a qualified mechanic.

## **WARRANTY INFORMATION:**

In the United States, see your Yamaha dealer for a copy of the Yamaha genuine parts and accessories limited warranty statement.

## **DEALER OR INSTALLER:**

These instructions contain important information for future reference and *must* be given to the customer.

No.	Part Number	Description	Qty.
--	B3J-E24E0-V0	Radiator Fan Kit	--
1	*	Blower Assembly	1
2	*	Capture Nut	3
3	*	Bolt with washer	3

\* Part supplied with kit only and not available separately.

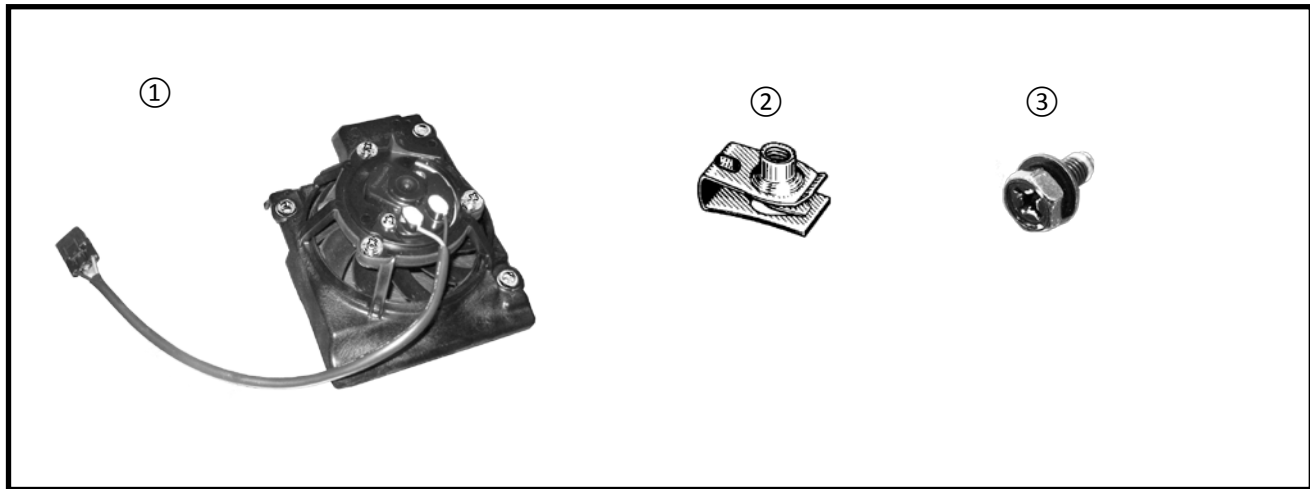

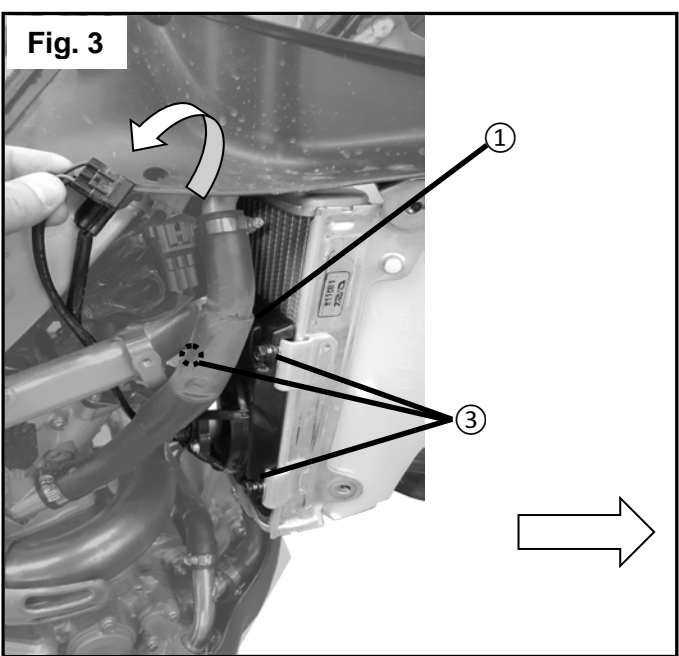
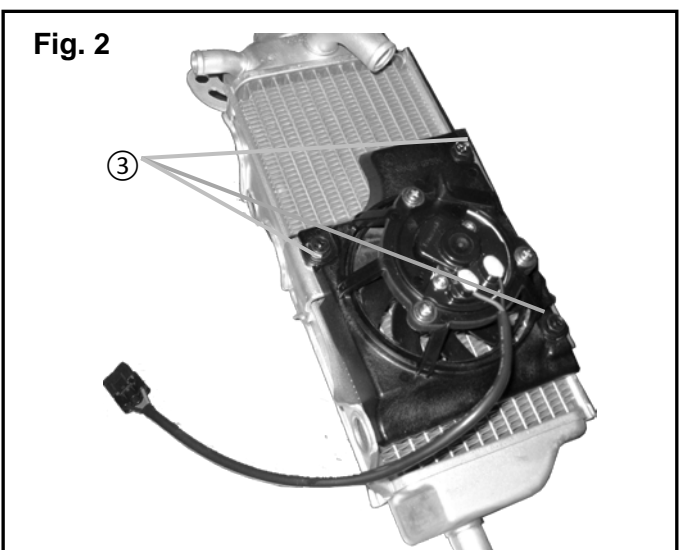
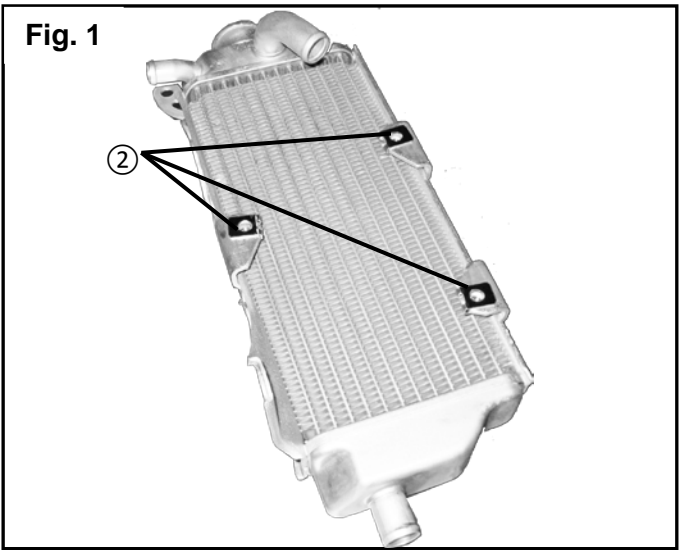

**PREPARATION:**

- Stand the motorcycle on a secure and level surface.
- Clean all mounting surfaces before beginning installation.

**INSTALLATION:**

Refer to the Owner's Service Manual when performing steps 1, 2, and 7.

1. Remove the seat, air filter cover, and right side radiator shroud.
2. Install the three capture nuts (2) to the right side radiator brackets as shown in Fig. 1.
3. Position the fan over the mount holes and install the bolts (3) to the capture nuts (2) as shown in Fig. 2.
4. Route the fan power cable behind the radiator hose as shown by the dotted line in Fig. 3.
5. Remove the dummy connector plug from the fan cable plug and connect the fan cable to the power connector as shown in Fig. 3.
6. Tighten the fan mount bolts to 9Nm (86.7 in. lbs.).
7. Reinstall the right side radiator shroud, air filter cover, and seat.

**MAINTENANCE:**

Periodically check the fasteners and re-tighten as needed.

**CUSTOMER SERVICE:**

For further information see your Yamaha dealer.

**ESTIMATED TIME TO INSTALL: 0.4 HRS.**